



21300 W 8 Mile Rd.
Southfield, MI 48075-5638

ENTRY-FIT™ "K2A-Series" ADJUSTABLE STEEL DOOR FRAME Utilizing a Steel Door Panel "IMPACT"

GENERAL NOTES

1. This product has been evaluated and is in compliance with the 5th Edition (2014) Florida Building Code (FBC) structural requirements including the "High Velocity Hurricane Zone" (HVHZ).
2. Product anchors shall be as listed and spaced as shown on details. Anchor embedment to base material shall be beyond wall dressing or stucco.
3. When used in the "HVHZ" this product complies with Section 1626 of the Florida Building Code and does not require an impact resistant covering.
4. When used in areas outside of the "HVHZ" requiring wind borne debris protection this product complies with Section 1609.1.2 of the FBC and does not require an impact resistant covering. This product meets missile level "D" and includes Wind Zone 4 as defined in ASTM E 1996 and Section 1609.1.2.2 of the FBC.
5. This product has been tested with the door panels as specified in this approval. Substitution of a similar product may be approved for use by the local Authority Having Jurisdiction. In all cases, the steel door used must possess a comparable current Florida Statewide product approval. The door panel size and design pressure (DP) rating shall not exceed the sizes and DP ratings shown in this approval or the steel side hinged swing door approval being used.
6. Site conditions that deviate from the details of this drawing require further engineering analysis by a licensed engineer or registered architect.
7. Configurations utilizing the high-dam outswing bump threshold (item #30) meet water infiltration requirements for the "HVHZ".
8. Configurations utilizing inswing threshold (item #31), outswing threshold (item #32) and the ADA threshold (item #33), do not meet the water infiltration requirements for the "HVHZ". These units shall be installed only in non-habitable areas or at habitable locations protected by an overhang or canopy such that the angle between the edge of canopy or overhang to sill is less than 45 degrees.
9. When used in the "HVHZ", steel must be protected as specified in FBC Section 2222.6.

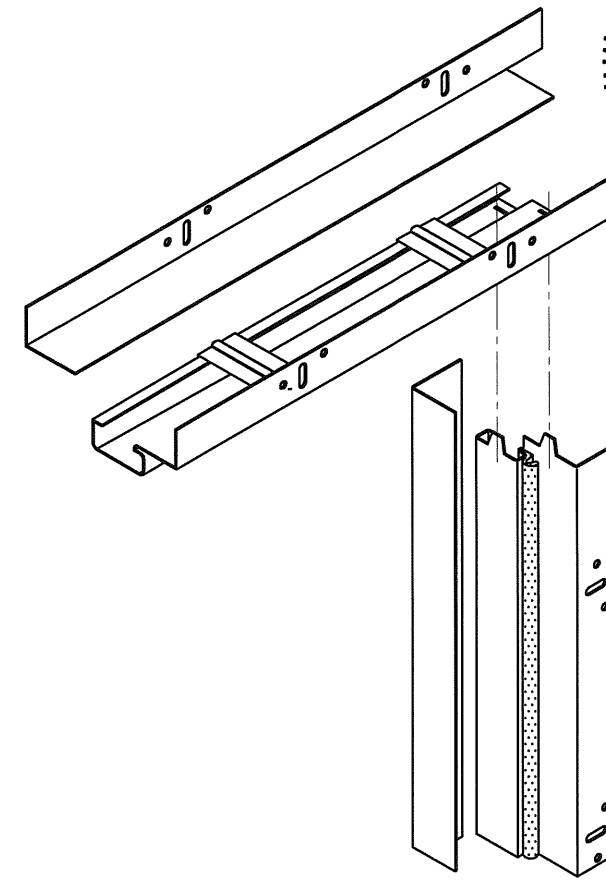
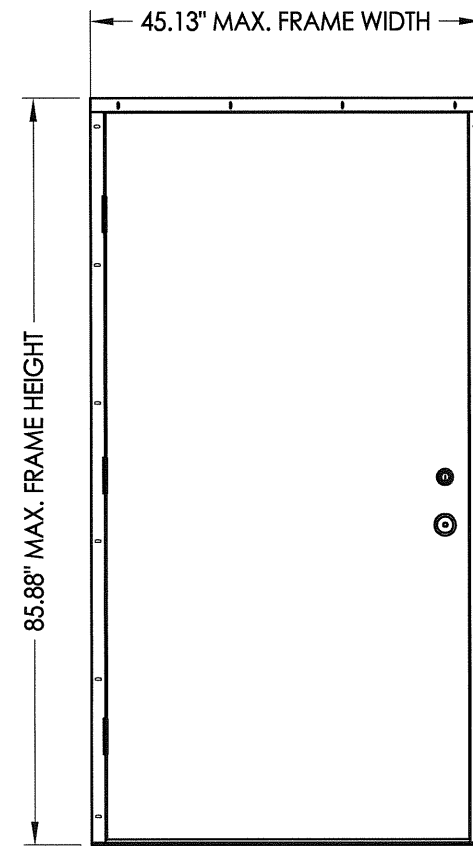

INSWING OR OUTSWING

**ADJUSTABLE STEEL DOOR FRAME
K2A-Series**

DOOR PANEL	OVERALL FRAME DIMENSION	DESIGN PRESSURE (PSF)		APPROVED FOR USE IN THE "HVHZ"
		POSITIVE	NEGATIVE	
TAYLOR	45.13" X 85.88"	+ 60.0	- 60.0	YES
MASONITE	39.13" X 85.88"	+ 60.0	- 60.0	NO

TABLE OF CONTENTS	
SHEET#	DESCRIPTION
1	Typical elevations, design pressures & general notes
2	Door panel details
3	Door panel details
4	Corner detail
5	Elevations
6	Horizontal cross sections
7	Vertical cross sections
8	Buck anchoring
9	Frame anchoring
10	Bill of materials and components

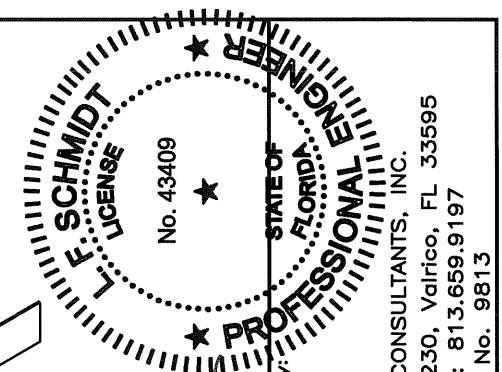

Documents Prepared By:
Lyndon F. Schmidt
P.E. No. 43409
RW
BUILDING CONSULTANTS, INC.
P.O. Box 230, Valrico, FL 33595
Phone No.: 813.659.9197
FBPE C.A. No. 9813

PRODUCT:
IDP
STEEL FRAME (K2A-SERIES)
PART OR ASSEMBLY:
TYPICAL ELEVATION, DESIGN PRESSURE & GENERAL NOTES

NO.	DATE	REVISIONS
3	1/27/15	UPDATE TO 5TH ED. (2014) FBC
2	5/21/12	UPDATE TO 2010 FBC
1	5/17/11	REV. THRESHOLD NOTES/ANCHORS
		BY

DATE: 4/11/11
SCALE: N.T.S.
DWG. BY: JK
CHK. BY: LFS
DRAWING NO.: FL-14512.1
SHEET 1 OF 10

R:\Clients\IDP PERMANENT\Florida Product Approvals\FL-14512\Drawings\Current\FL-14512.1-3.dwg, FL-14512.1

© 2011 R.W. BUILDING CONSULTANTS INC.

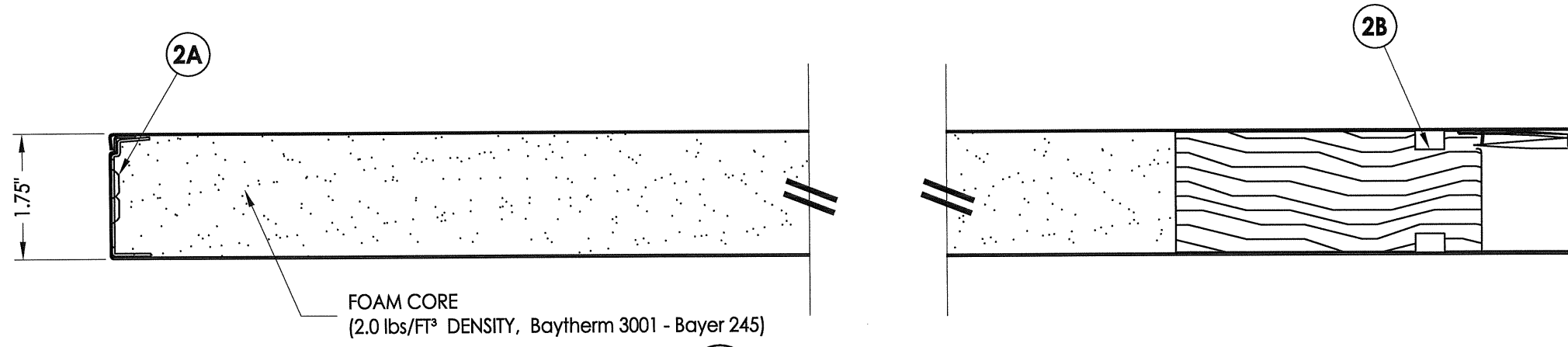

1 HORIZONTAL CROSS SECTION
2

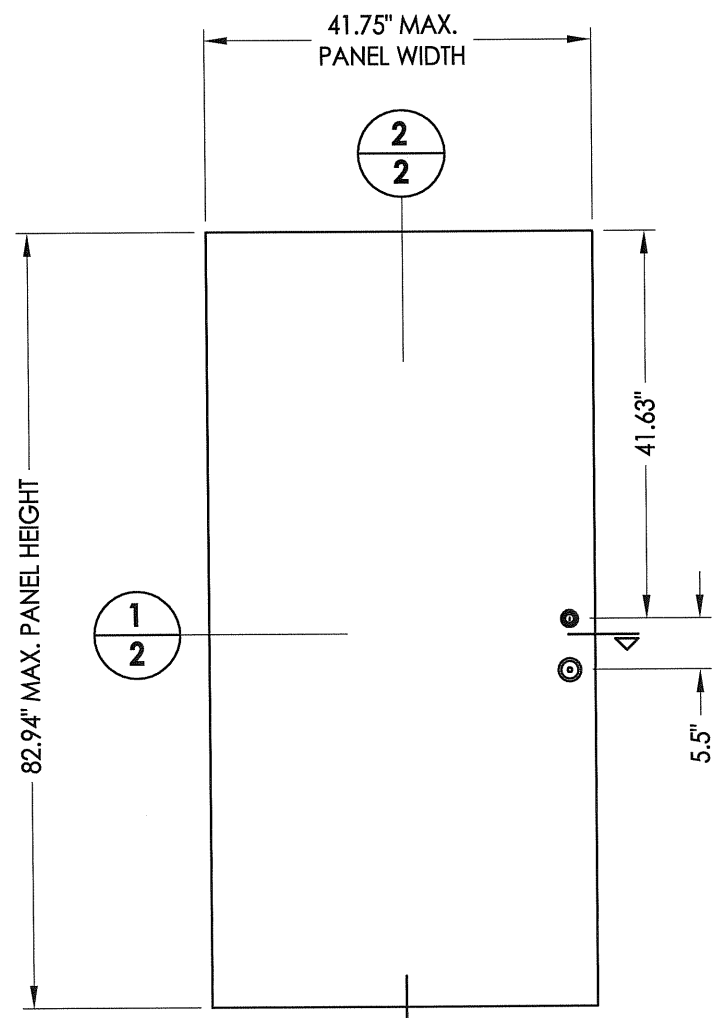

40 DOOR PANEL
Steel (Taylor)

STEEL DOOR SKIN: MIN. 0.020" THK.
GALVANIZED STEEL (F_y = 33,000 PSI MIN.)

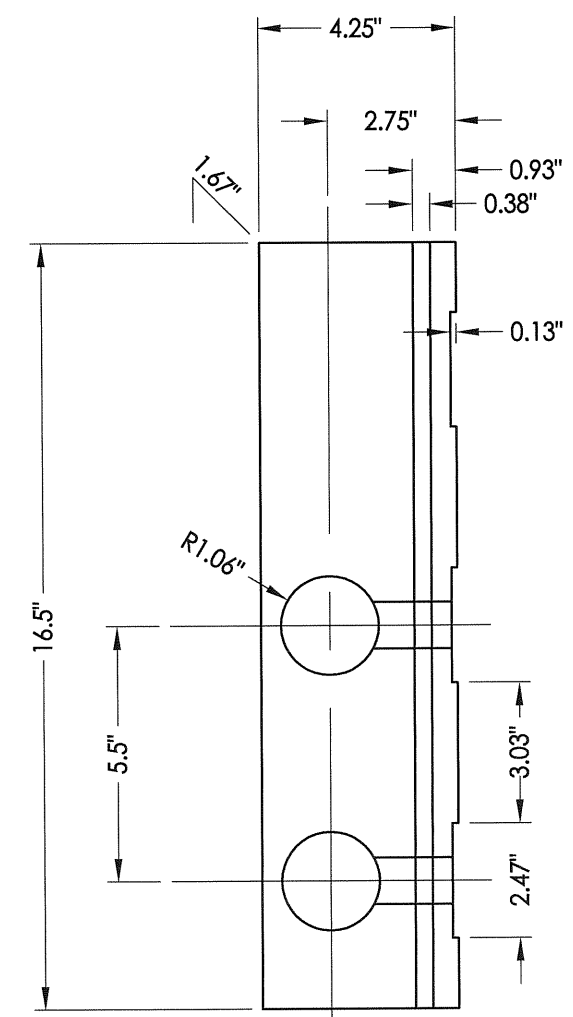

2B LOCK BLOCK
Wood

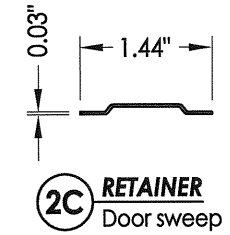
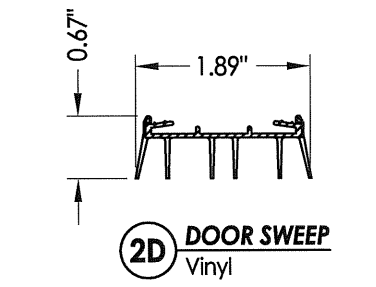

STEEL DOOR SKIN

2C
2D

2 VERTICAL CROSS SECTION
2

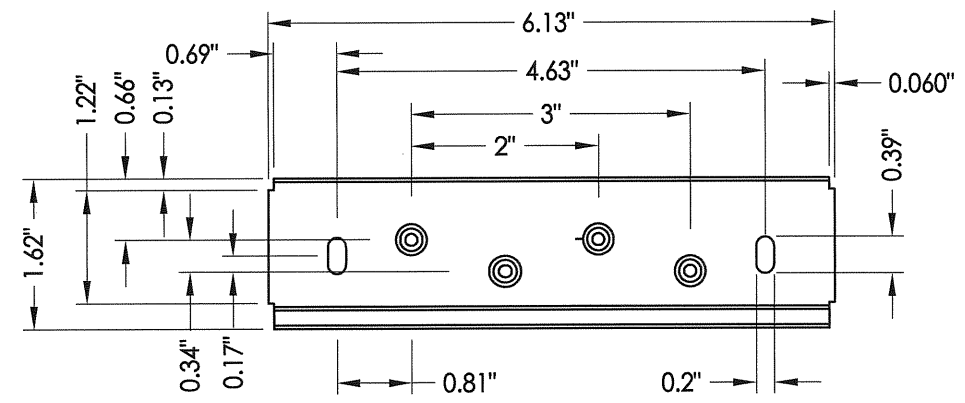

2A HINGE REINFORCEMENT

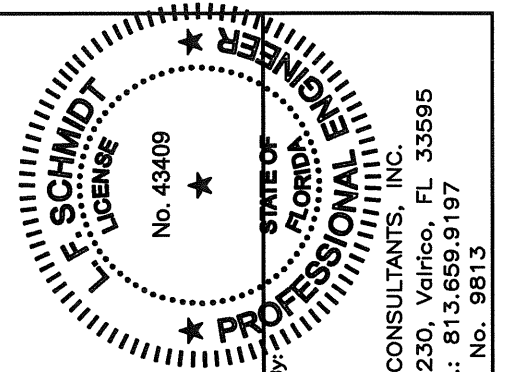
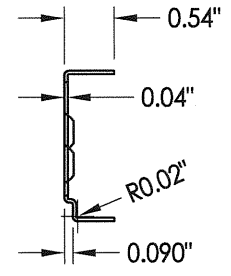

Documents Prepared By:
Lyndon F. Schmidt
P.E. No. 43409

R.W. BUILDING CONSULTANTS, INC.
P.O. Box 230, Vairico, FL 33595
Phone No.: 813.659.9197
FBPE C.A. No. 9813

PRODUCT:		IDP STEEL FRAME (K2A-SERIES)	
PART OR ASSEMBLY:		DOOR PANEL DETAILS	
NO.	DATE	BY	REVISIONS
3	1/27/15	JK	UPDATE TO 5TH ED. (2014) FBC
2	5/21/12	LFS	UPDATE TO 2010 FBC
1	5/17/11	LFS	REV. THRESHOLD NOTES/ANCHORS

DATE: 4/11/11
SCALE: N.T.S.
DWG. BY: JK
CHK. BY: LFS
DRAWING NO.: FL-14512.1
SHEET 2 of 10

R:\Clients\IDP PERMANENT\Florida Product Approvals\FL-14512\Drawings\Current\FL-14512.1-3.dwg, 3.1

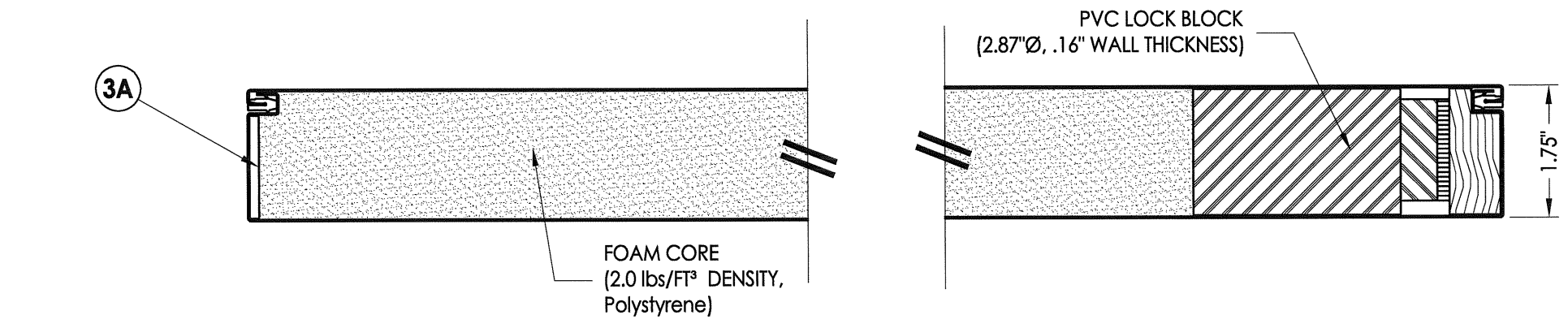

1
3 **HORIZONTAL CROSS SECTION**

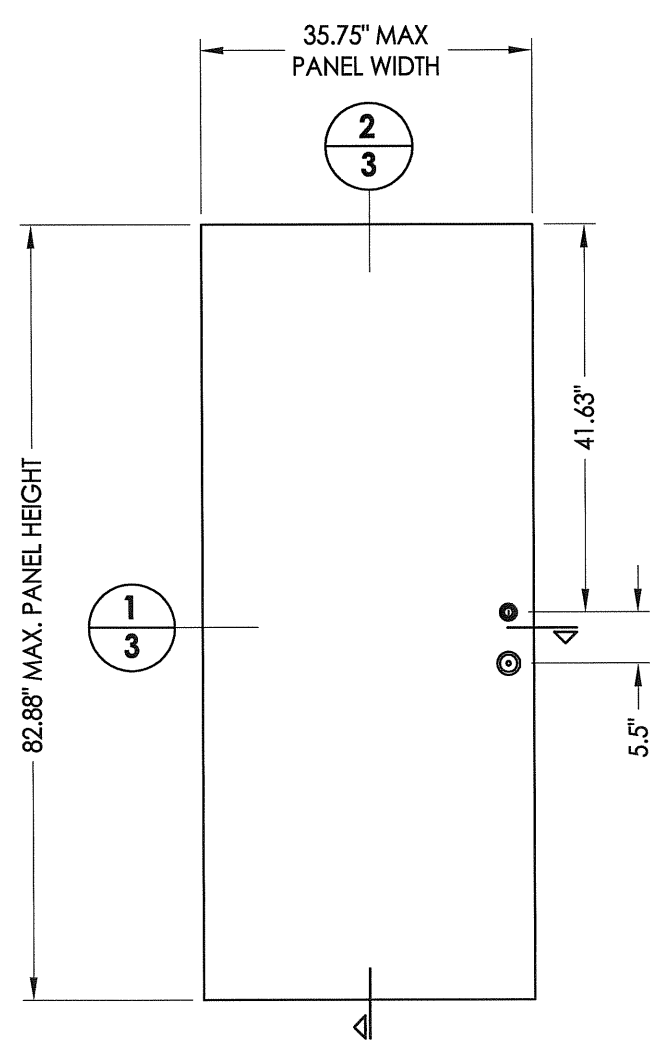

50 **DOOR PANEL**
Steel (Masonite)

STEEL DOOR SKIN: MIN. 0.020" THK.
GALVANIZED STEEL (F_y = 50,000 PSI MIN.)

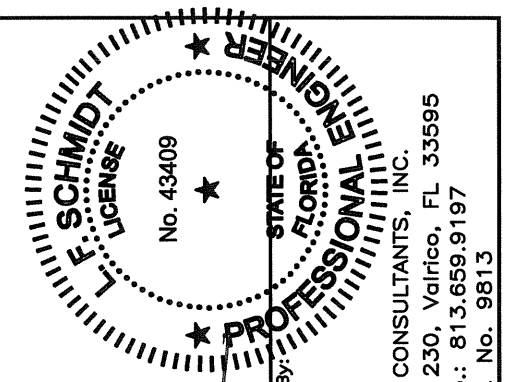
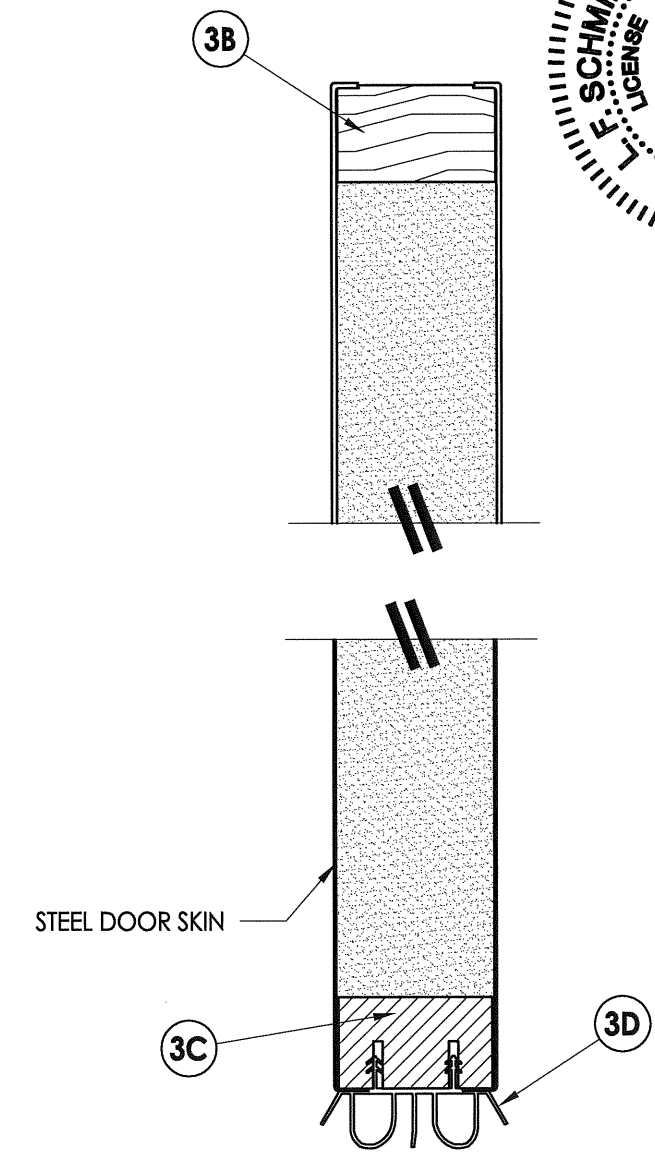
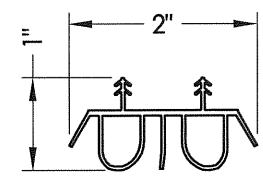
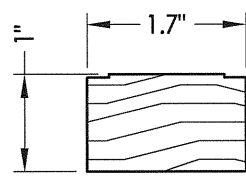
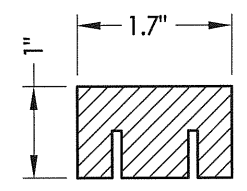
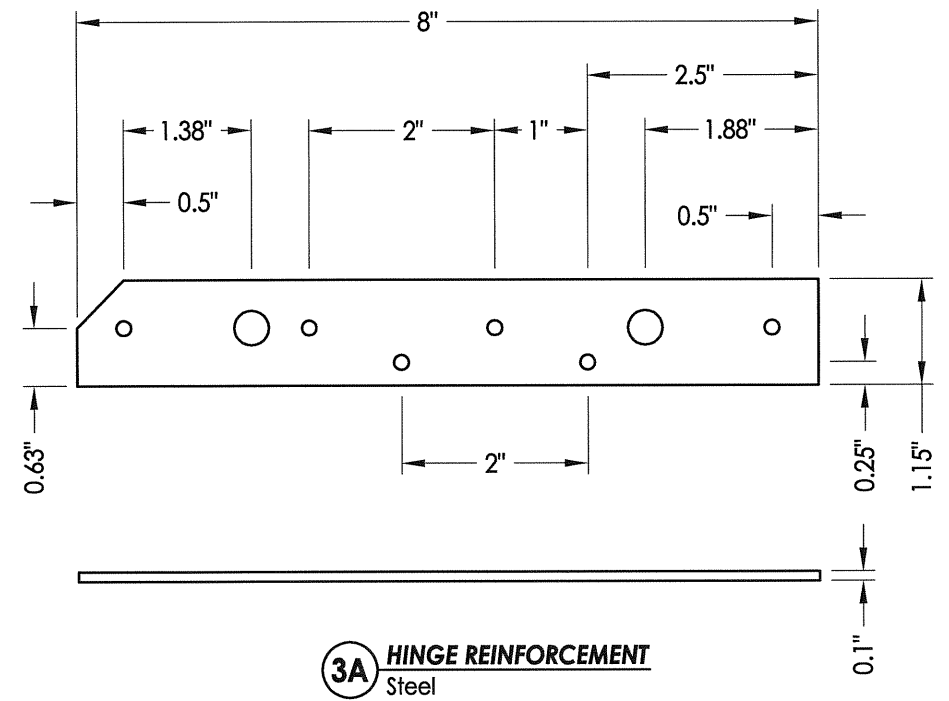

Documents Prepared By:
Lyndon F. Schmidt
P.E. No. 43409

RW
BUILDING CONSULTANTS, INC.
P.O. Box 230, Valrico, FL 33595
Phone No.: 813.659.9197
FBPE C.A. No. 9813

PRODUCT:		IDP STEEL FRAME (K2A-SERIES)	
PART OR ASSEMBLY:		DOOR PANEL DETAILS	
NO.	DATE	REV.	REVISIONS
3	1/27/15	UPDATE TO 5TH ED. (2014) FBC	JK
2	5/21/12	UPDATE TO 2010 FBC	LFS
1	5/17/11	REV. THRESHOLD NOTES/ANCHORS	LFS
NO.	DATE	REV.	REVISIONS
DATE: 4/11/11		SCALE: N.T.S.	
DWG. BY: JK		CHK. BY: LFS	
DRAWING NO.: FL-14512.1		SHEET 3 of 10	

NOTE: Max frame size with Masonite door is 39.13" X 85.88"

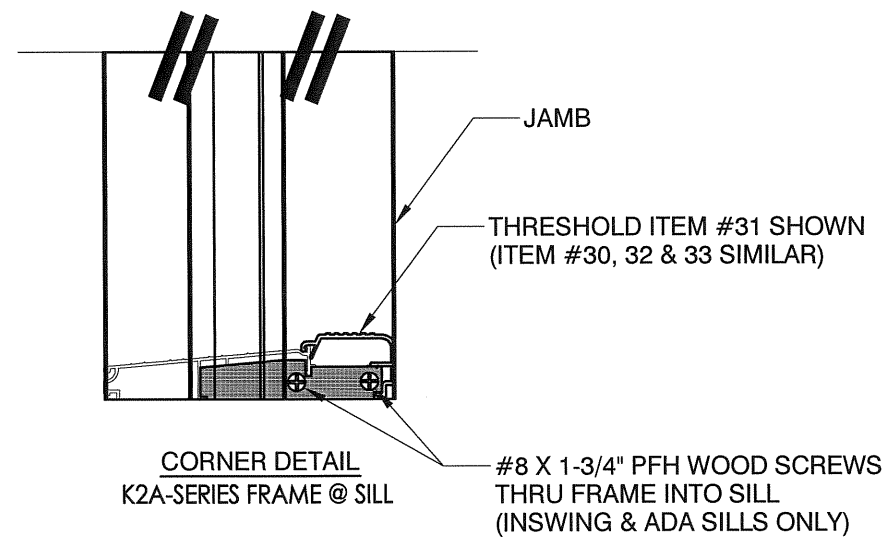

CORNER DETAIL
K2A-SERIES FRAME @ SILL

#8 X 1-3/4" PFH WOOD SCREWS
THRU FRAME INTO SILL
(INSWING & ADA SILLS ONLY)

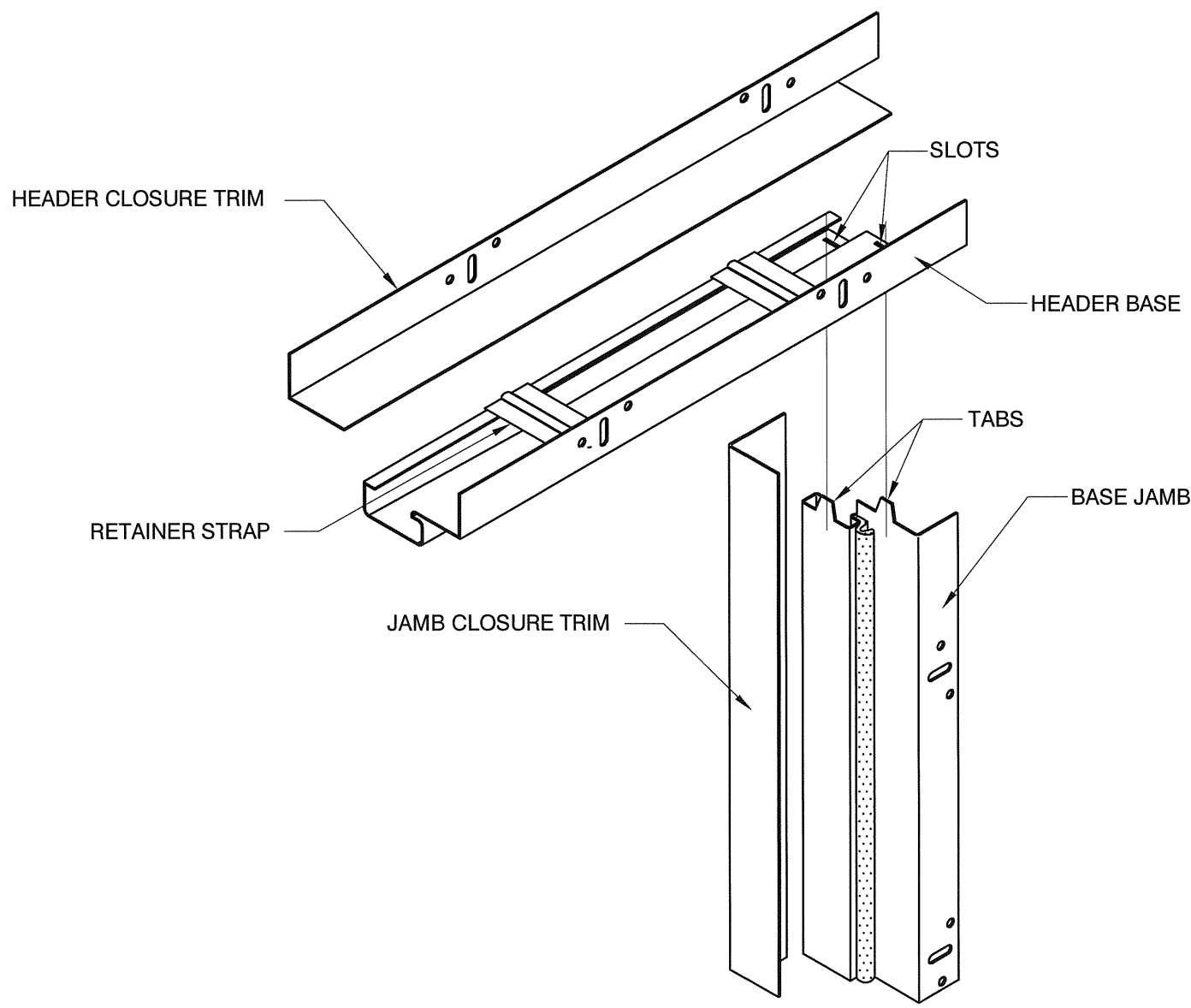

CORNER DETAIL
IDP ENTRY-FIT™ ADJUSTABLE
STEEL DOOR FRAME (K2A-SERIES)

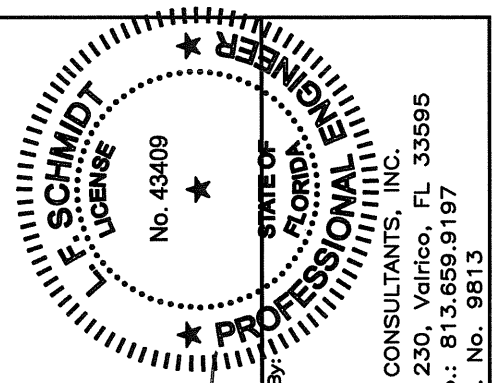

LFS
2-26-15

Documents Prepared By:
Lyndon F. Schmidt
P.E. No. 43409

RW
BUILDING CONSULTANTS, INC.
P.O. Box 230, Valrico, FL 33595
Phone No.: 813.659.9197
FBPE C.A. No. 9813

PRODUCT:	STEEL FRAME (K2A-SERIES)
PART OR ASSEMBLY:	CORNER DETAIL

NO.	DATE	REVISIONS	BY
3	1/27/15	UPDATE TO 5TH ED. (2014) FBC	JK
2	5/21/12	UPDATE TO 2010 FBC	LFS
1	5/17/11	REV. THRESHOLD NOTES/ANCHORS	LFS

DATE:	4/11/11
SCALE:	N.T.S.
DWG. BY:	JK
CHK. BY:	LFS
DRAWING NO.:	FL-14512.1
SHEET	4 OF 10

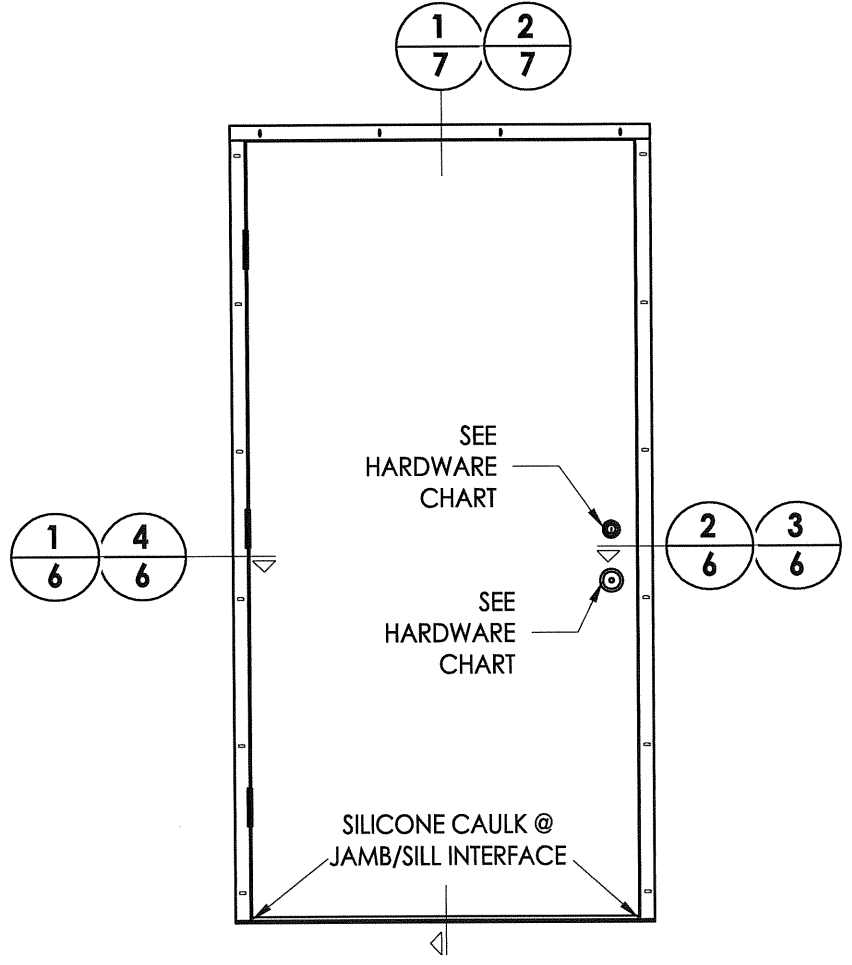

TAYLOR DOOR

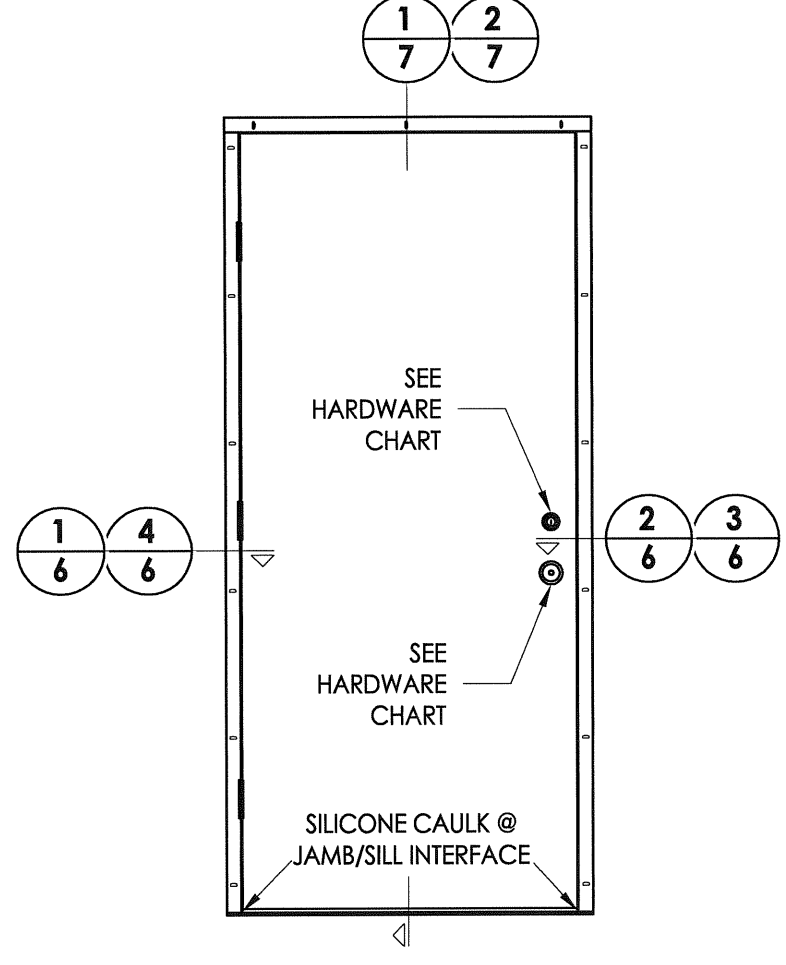

MASONITE DOOR

HARDWARE CHART	
MANUFACTURER	MODEL
KWIKSET	LOCK: SIGNATURE SERIES DEADBOLT: SIGNATURE SERIES (980)
SCHLAGE	LEVER: "F" SERIES (F51) DEADBOLT: "B" SERIES (B300)

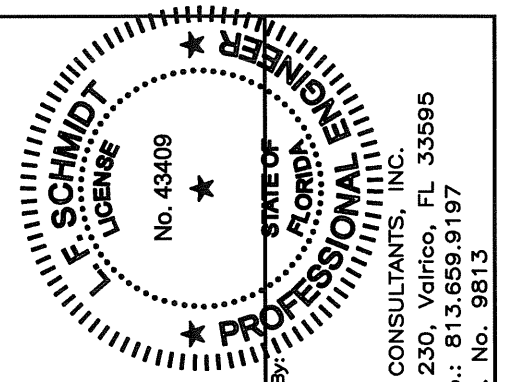

LFS
 2.26.11
 Documents Prepared By:
 Lyndon F. Schmidt
 P.E. No. 43409
RW
 BUILDING CONSULTANTS, INC.
 P.O. Box 230, Valrico, FL 33595
 Phone No.: 813.659.9197
 FBPE C.A. No. 9813

PRODUCT:	STEEL FRAME (K2A-SERIES)
PART OR ASSEMBLY:	ELEVATIONS
DATE:	4/11/11
SCALE:	N.T.S.
DWG. BY:	JK
CHK. BY:	LFS
DRAWING NO.:	FL-14512.1
SHEET	5 OF 10

R:\Clients\IDP PERMANENT\Florida Product Approvals\FL-14512\Drawings\Current\FL-14512.1-3.dwg, 6.1

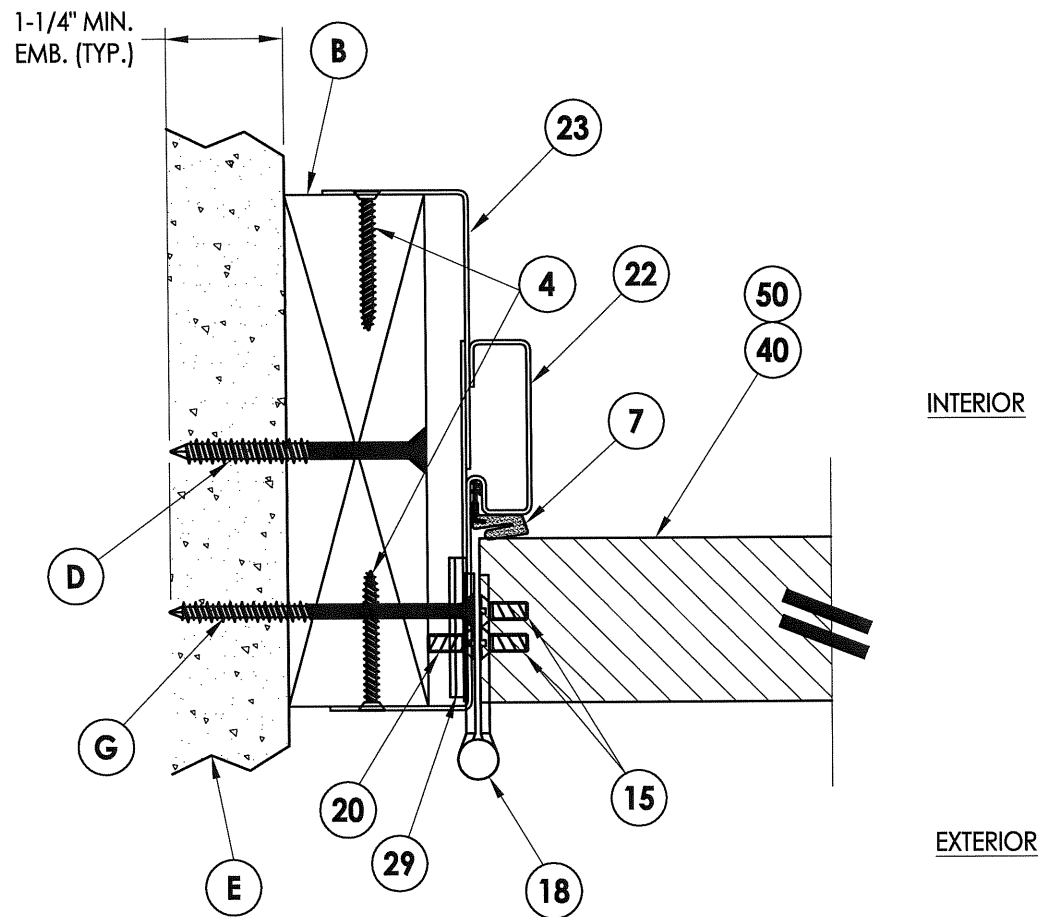

1 HORIZONTAL CROSS SECTION
6 2x Buck Construction

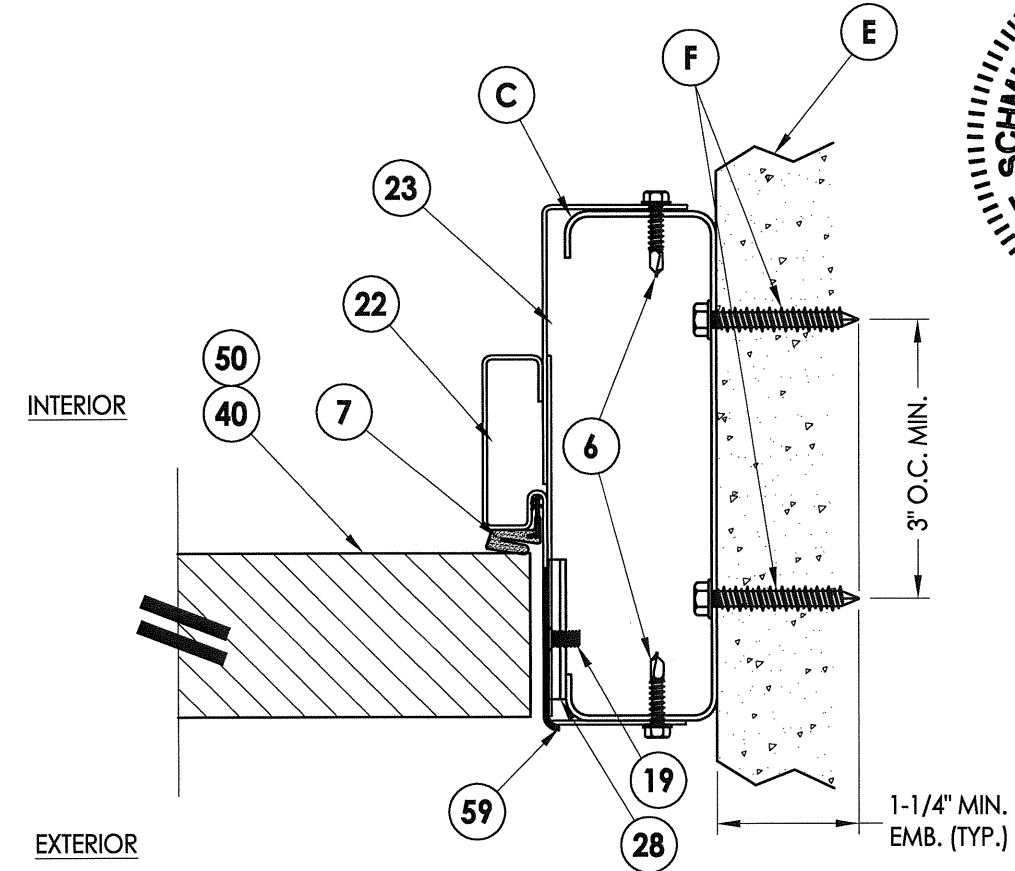

2 HORIZONTAL CROSS SECTION
6 Metal Stud Construction

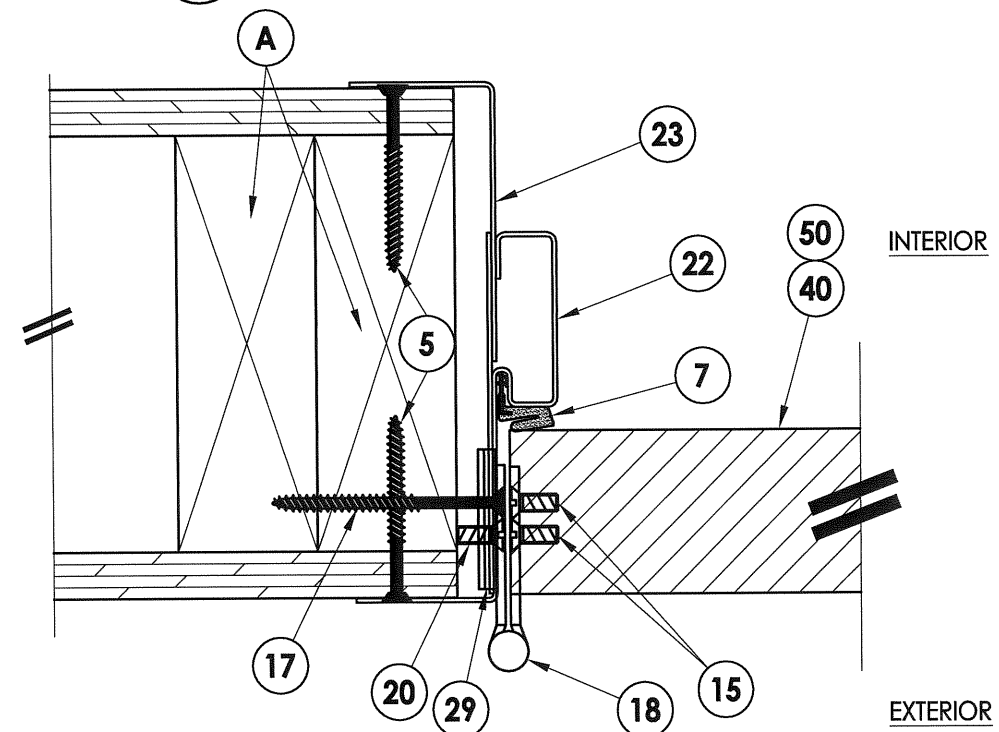

4 HORIZONTAL CROSS SECTION
6 2x Stud Construction

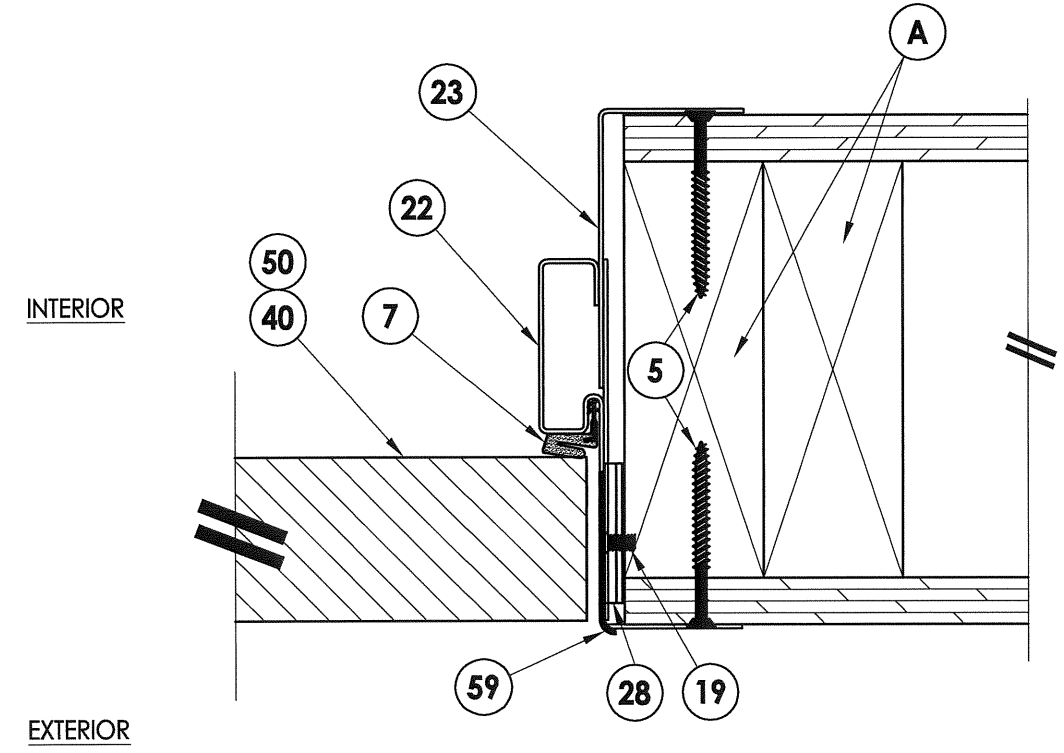

3 HORIZONTAL CROSS SECTION
6 2x Stud Construction

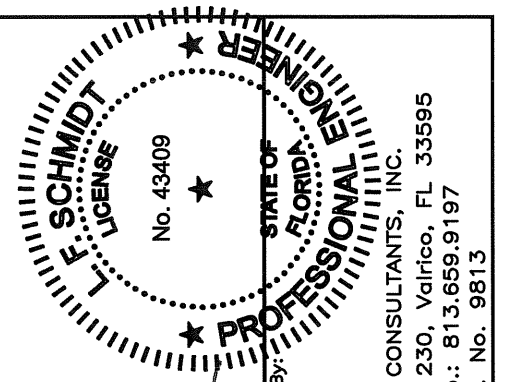

Documents Prepared By:
Lyndon F. Schmidt
P.E. No. 43409
R.W. BUILDING CONSULTANTS, INC.
P.O. Box 230, Vairico, FL 33595
Phone No.: 813.659.9197
FBPE C.A. No. 9813

PRODUCT:	IDP
	STEEL FRAME (KZA-SERIES)
PART OR ASSEMBLY:	HORIZONTAL CROSS SECTIONS

NO.	DATE	REVISIONS
3	1/27/15	UPDATE TO 5TH ED. (2014) FBC JK
2	5/21/12	UPDATE TO 2010 FBC LFS
1	5/17/11	REV. THRESHOLD NOTES/ANCHORS LFS

DATE:	4/11/11
SCALE:	N.T.S.
DWG. BY:	JK
CHK. BY:	LFS
DRAWING NO.:	FL-14512.1
SHEET	6 OF 10

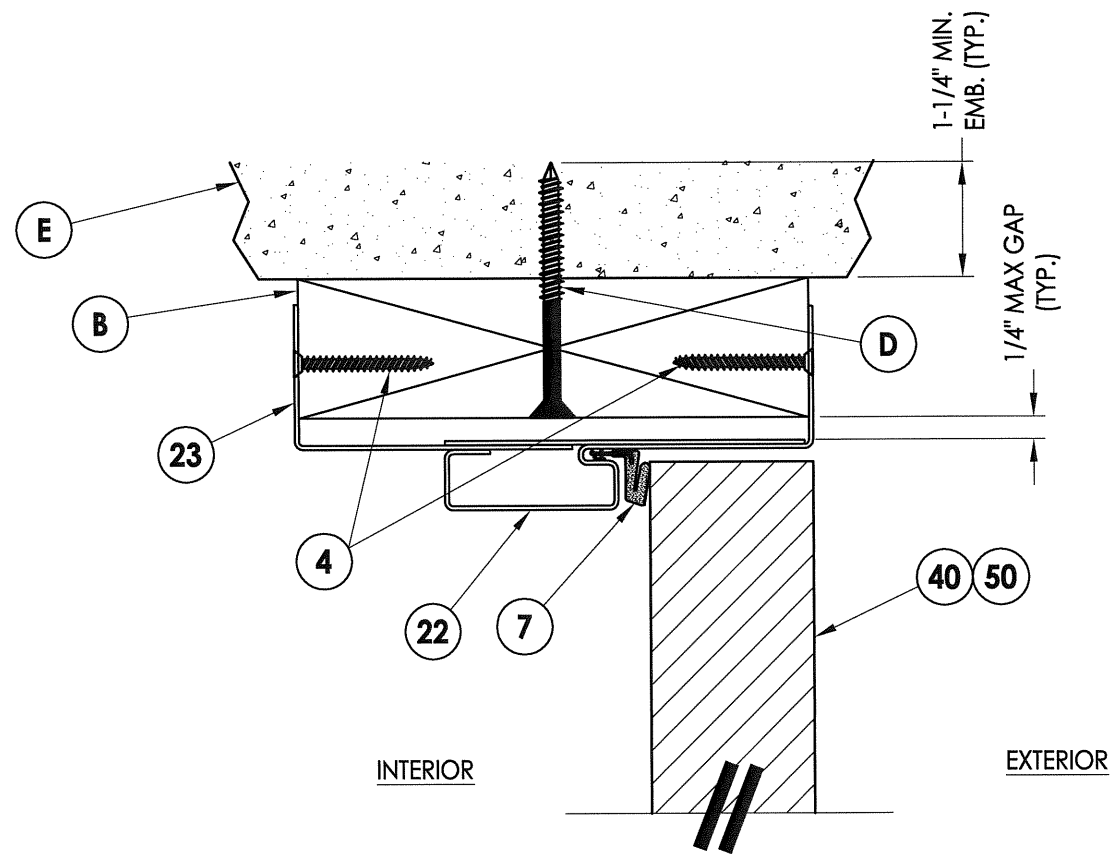

1 VERTICAL CROSS SECTION
7 Outswing

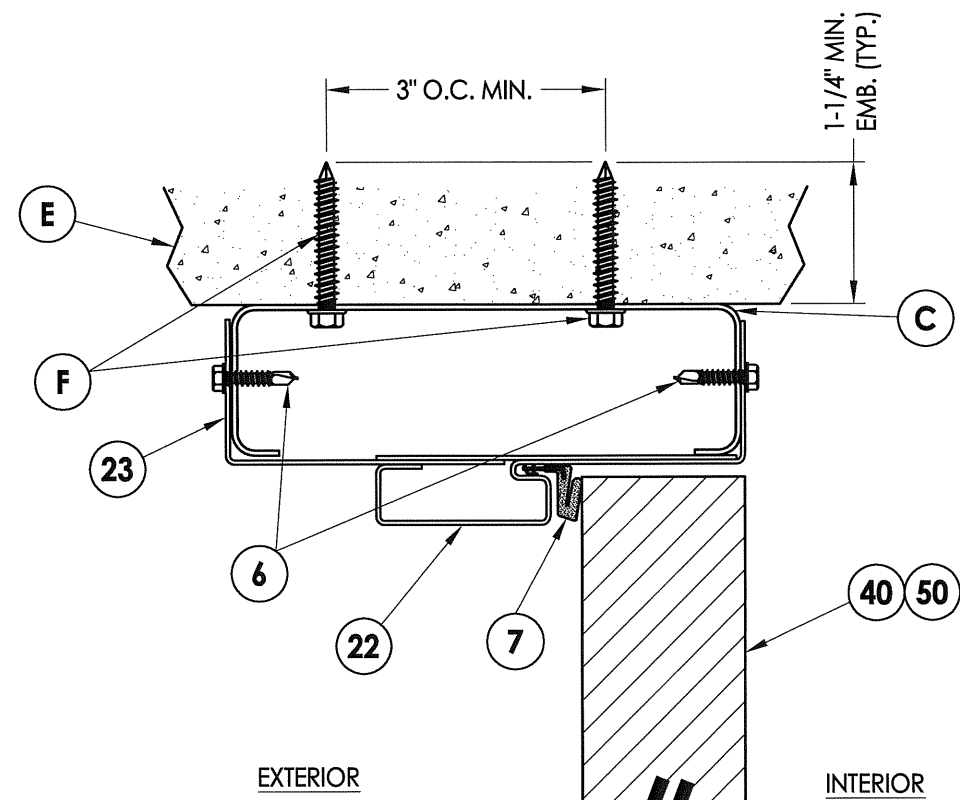
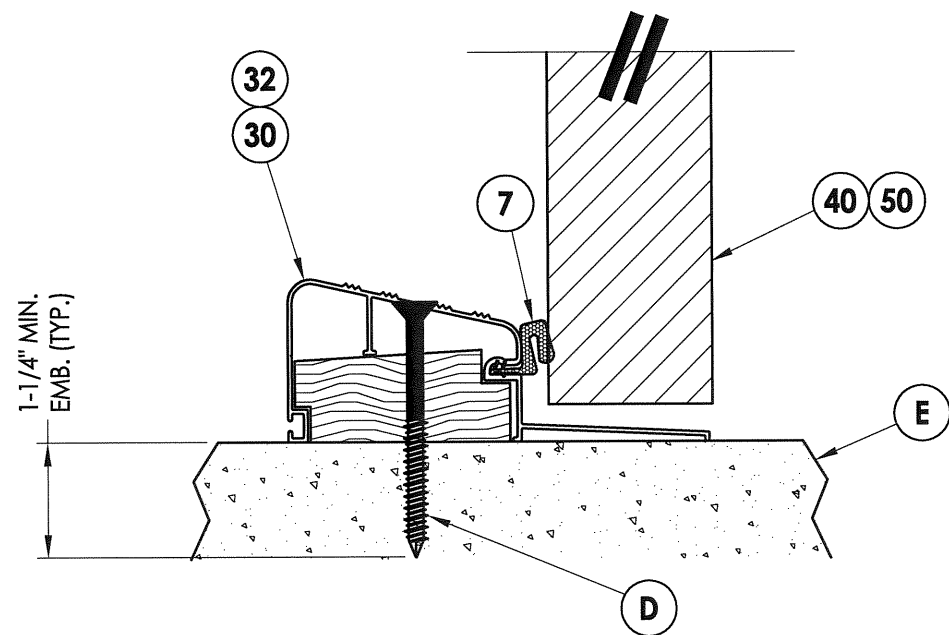

2 VERTICAL CROSS SECTION
7 Inswing

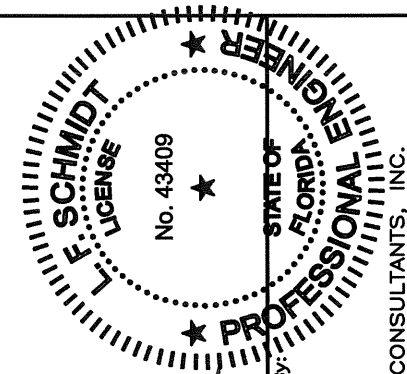
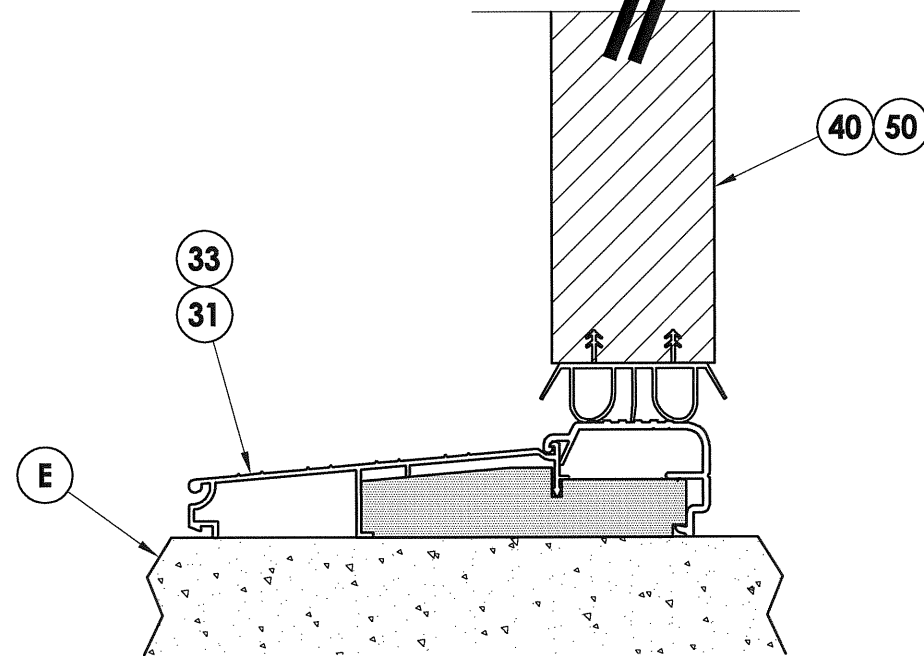

Documents Prepared By:
Lyndon F. Schmidt
P.E. No. 43409

R.W. BUILDING CONSULTANTS, INC.
P.O. Box 230, Valrico, FL 33595
Phone No.: 813.659.9197
FBPE C.A. No. 9813

PRODUCT:
IDP
STEEL FRAME (K2A-SERIES)
PART OR ASSEMBLY:
VERTICAL CROSS SECTIONS

NO.	DATE	REVISIONS
3	1/27/15	UPDATE TO 5TH ED. (2014) FBC JK
2	5/21/12	UPDATE TO 2010 FBC LFS
1	5/17/11	REV. THRESHOLD NOTES/ANCHORS LFS
		BY

DATE: 4/11/11
SCALE: N.T.S.
DWG. BY: JK
CHK. BY: LFS
DRAWING NO.: FL-14512.1
SHEET 7 OF 10

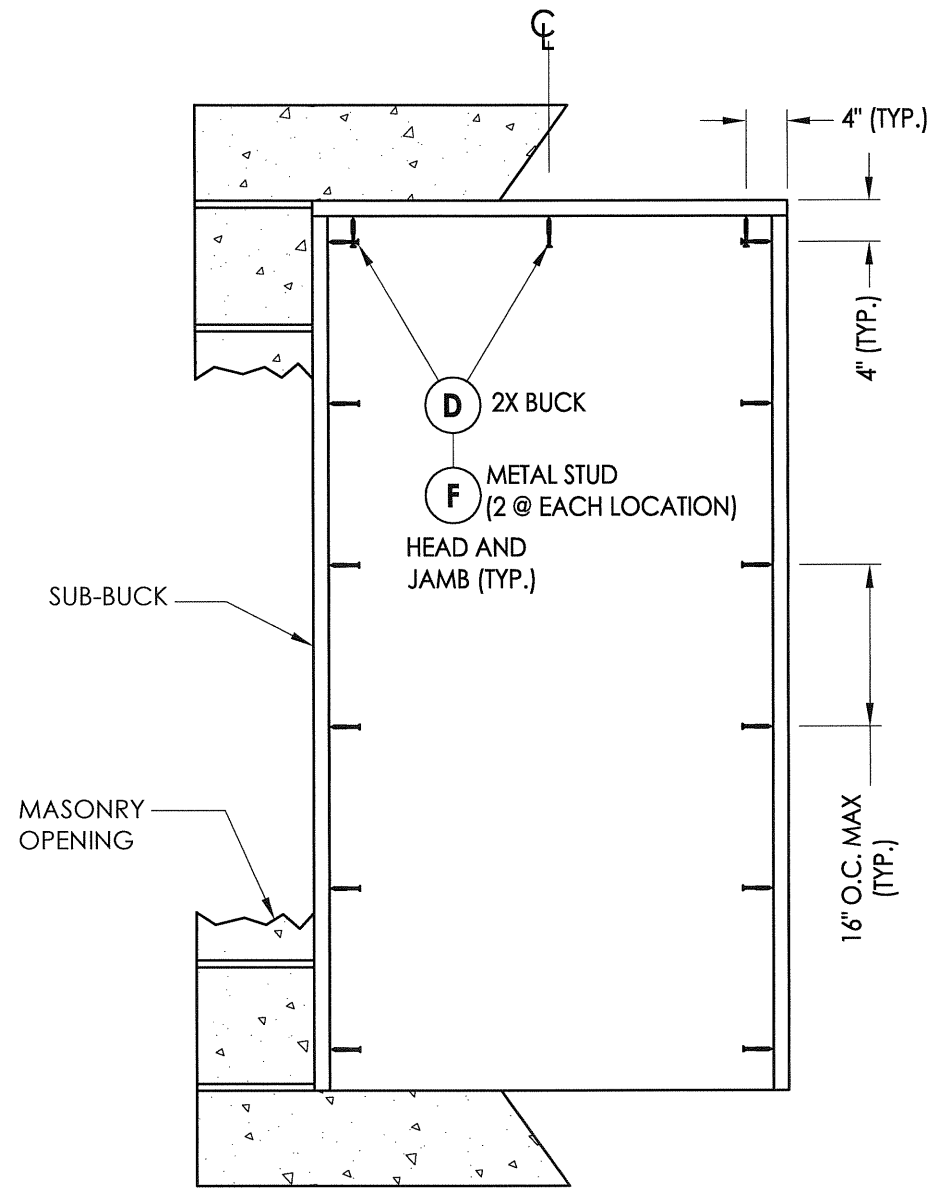

BUCK ANCHORING
Taylor Door

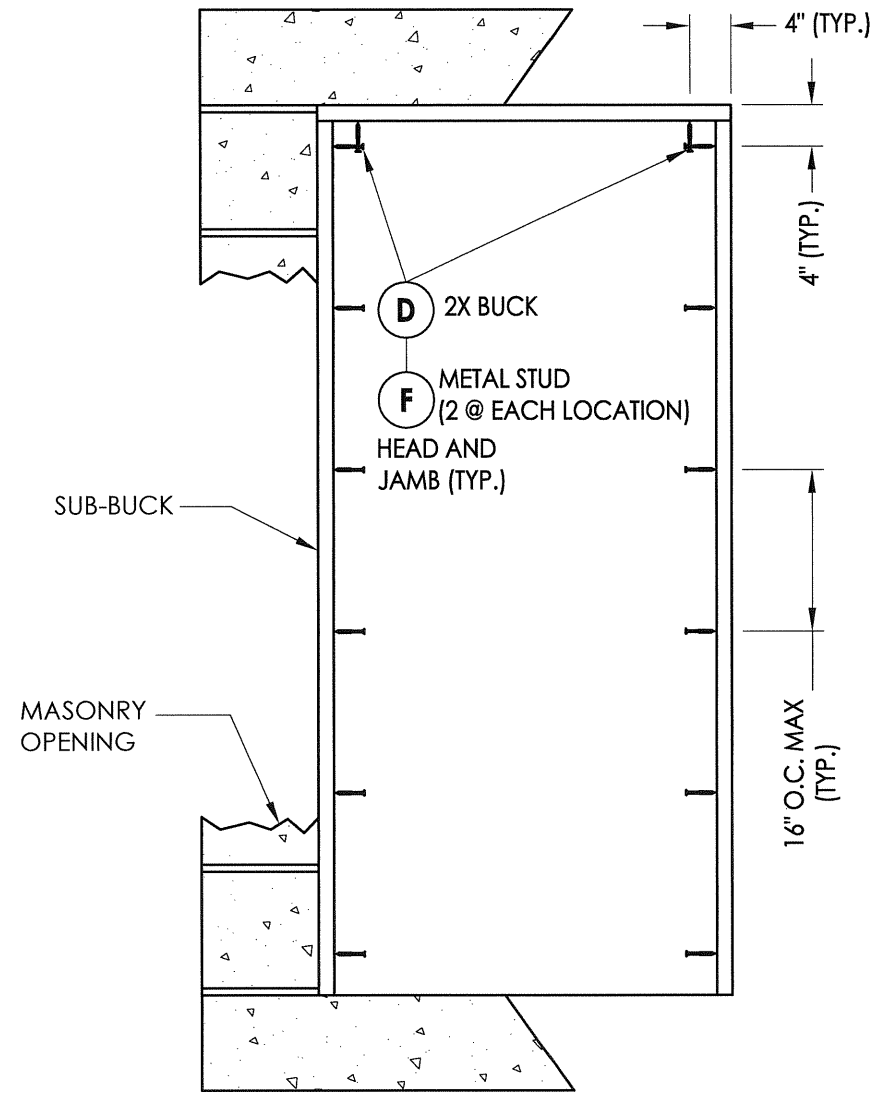

BUCK ANCHORING
Masonite Door

CONCRETE ANCHOR NOTES:

1. Concrete anchor locations at the corners may be adjusted to maintain the min. edge distance to mortar joints.
2. Concrete anchor locations noted as "MAX. ON CENTER" must be adjusted to maintain the min. edge distance to mortar joints, additional concrete anchors may be required to ensure the "MAX. ON CENTER" dimension are not exceeded.
3. Concrete anchor table:

ANCHOR TYPE	ANCHOR SIZE	MIN. EMBEDMENT	MIN. CLEARANCE TO MASONRY EDGE	MIN. CLEARANCE TO ADJACENT ANCHOR
ITW TAPCON®	1/4"	1-1/4"	2"	4"
ELCO ULTRACON®	1/4"	1-1/4"	1"	4"
ITW TAPCON®	3/16"	1-1/4"	3"	1-1/2"

WOOD SCREW INSTALLATION NOTES:

1. Maintain a minimum 5/8" edge distance, 1" end distance, & 1" o.c. spacing of wood screws to prevent the splitting of wood.

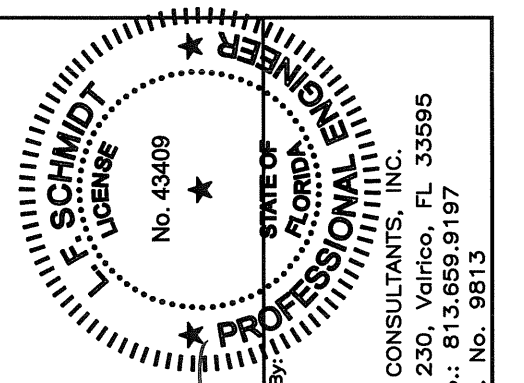

Documents Prepared By:
Lyndon F. Schmidt
P.E. No. 43409
RW
BUILDING CONSULTANTS, INC.
P.O. Box 230, Valrico, FL 33595
Phone No.: 813.659.9197
FBPE C.A. No. 9813

PRODUCT: IDP STEEL FRAME (K2A-SERIES)
PART OR ASSEMBLY: BUCK ANCHORING

NO.	DATE	REVISIONS
3	1/27/15	UPDATE TO 5TH ED. (2014) FBC JK
2	12/20/12	UPDATE TO 2010 FBC LFS
1	5/17/11	REV. THRESHOLD NOTES/ANCHORS LFS

DATE: 4/11/11
SCALE: N.T.S.
DWG. BY: JK
CHK. BY: LFS
DRAWING NO.: FL-14512.1
SHEET 8 OF 10

R:\Clients\IDP PERMANENT\Florida Product Approvals\FL-14512\Drawings\Current\FL-14512.1-3.dwg, 9.1

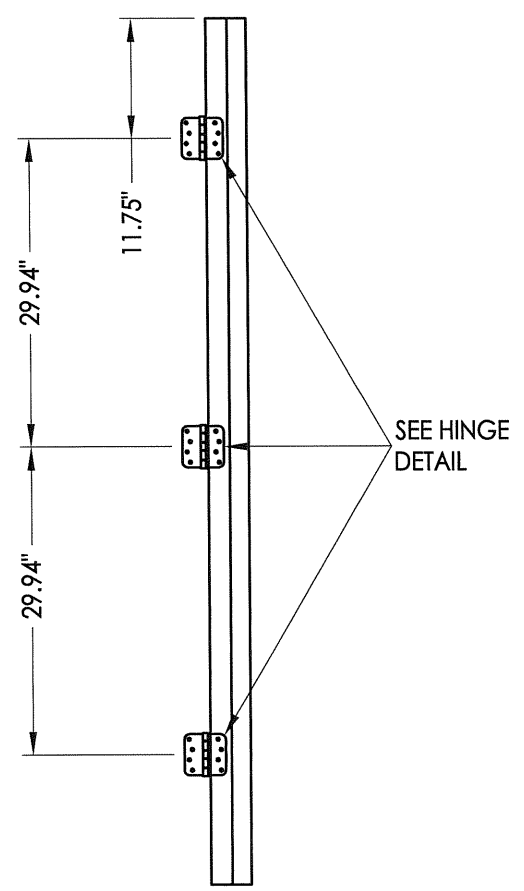

HINGE JAMB

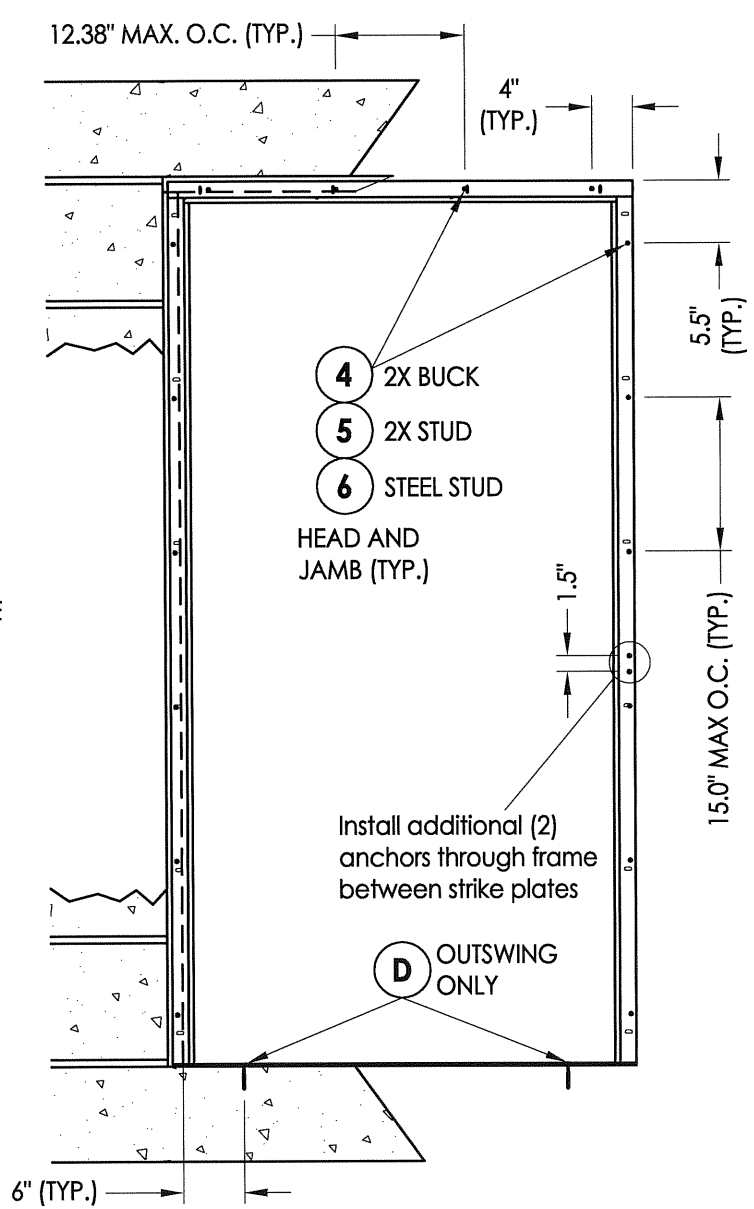

**FRAME ANCHORING
TAYLOR DOOR**

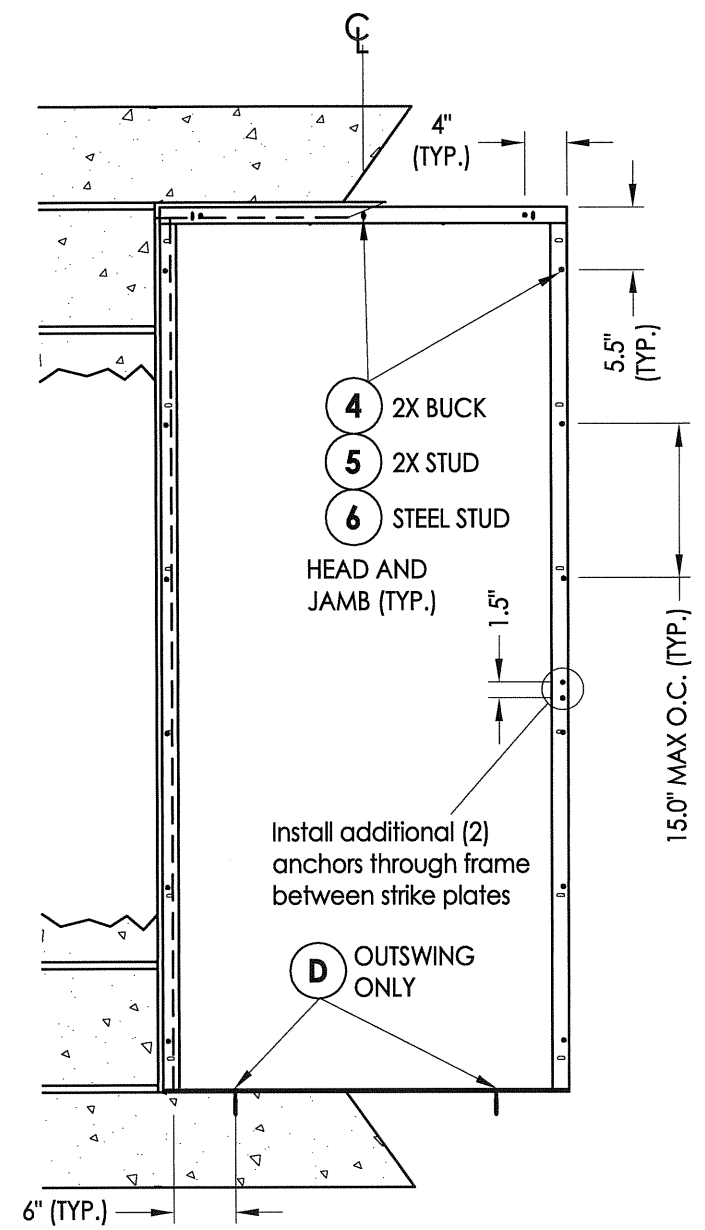

**FRAME ANCHORING
MASONITE DOOR**

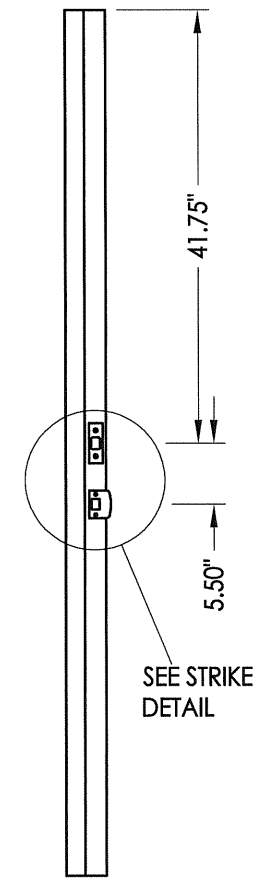

STRIKE JAMB

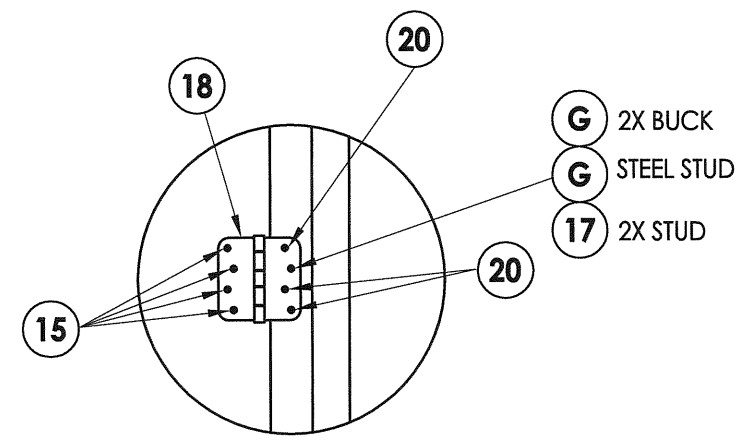

HINGE DETAIL

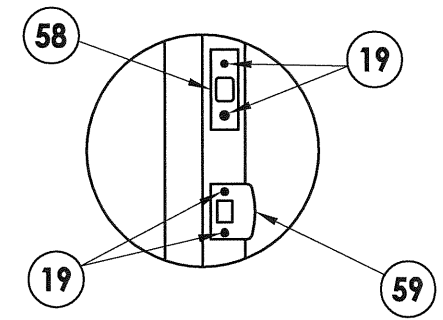

STRIKE PLATE DETAIL

CONCRETE ANCHOR NOTES:

1. Concrete anchor locations at the corners may be adjusted to maintain the min. edge distance to mortar joints.
2. Concrete anchor locations noted as "MAX. ON CENTER" must be adjusted to maintain the min. edge distance to mortar joints, additional concrete anchors may be required to ensure the "MAX. ON CENTER" dimension are not exceeded.
3. Concrete anchor table:

ANCHOR TYPE	ANCHOR SIZE	MIN. EMBEDMENT	MIN. CLEARANCE TO MASONRY EDGE	MIN. CLEARANCE TO ADJACENT ANCHOR
ITW TAPCON®	1/4"	1-1/4"	2"	4"
ELCO ULTRACON®	1/4"	1-1/4"	1"	4"
ITW TAPCON®	3/16"	1-1/4"	3"	1-1/2"

WOOD SCREW INSTALLATION NOTES:

1. Maintain a minimum 5/8" edge distance, 1" end distance, & 1" o.c. spacing of wood screws to prevent the splitting of wood.

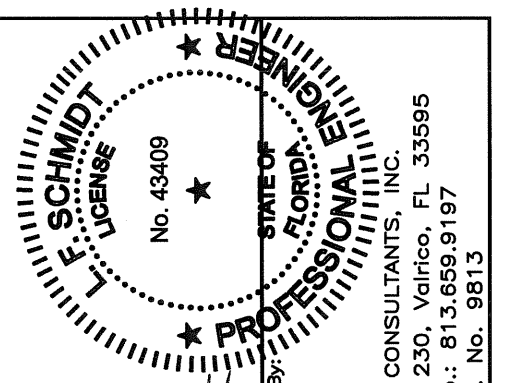

Documents Prepared By:
Lyndon F. Schmidt
P.E. No. 43409

RW BUILDING CONSULTANTS, INC.
P.O. Box 230, Vairico, FL 33595
Phone No.: 813.659.9197
FBPE C.A. No. 9813

PRODUCT: IDP STEEL FRAME (K2A-SERIES)

PART OR ASSEMBLY: FRAME ANCHORING

NO.	DATE	REVISIONS
3	1/27/15	UPDATE TO 5TH ED. (2014) FBC
2	12/20/12	UPDATE TO 2010 FBC
1	5/17/11	REV. THRESHOLD NOTES/ANCHORS
		BY

DATE: 4/11/11
SCALE: N.T.S.
DWG. BY: JK
CHK. BY: LFS
DRAWING NO.: FL-14512.1
SHEET 9 OF 10

